

**Crimping contact
HDC-C-HE-SM2.5AG**

Weidmüller Interface GmbH & Co. KG
Klingenbergstraße 16
D-32758 Detmold
Germany
Fon: +49 5231 14-0
Fax: +49 5231 14-292083
www.weidmueller.com



Crimps provide a electrical and mechanical connection between wire and contact that is both secure and reliable. The optimal crimp connection is gas-tight and corrosion-resistant.

General ordering data

| | |
|------------|--|
| Type | HDC-C-HE-SM2.5AG |
| Order No. | 1200800000 |
| Version | Heavy Duty Connectors, Crimp contact, HE, HEE, HQ, MixMate, Male, Conductor cross-section, max.: 2.5, turned, Copper alloy |
| GTIN (EAN) | 4008190131913 |
| Qty. | 100 pc(s). |

Crimping contact HDC-C-HE-SM2.5AG

Weidmüller Interface GmbH & Co. KG
 Klingenbergstraße 16
 D-32758 Detmold
 Germany
 Fon: +49 5231 14-0
 Fax: +49 5231 14-292083
 www.weidmueller.com

Technical data

Dimensions and weights

| | | | |
|------------|--------|----------|--------|
| Net weight | 1.24 g | Diameter | 4.5 mm |
|------------|--------|----------|--------|

General data

| | | | |
|------------------------------------|----------------------|----------------------------------|---------------------|
| Contact diameter, male Ø | 2.5 mm | Cross-section for connected wire | 2.5 mm ² |
| Material | Copper alloy | Plugging cycles | ≥ 500 |
| Production methods | turned | Series | HE |
| Stripping length, rated connection | 7.5 mm | Surface finish | silver |
| Type | Male | Type of connection | Crimp connection |
| Version insert | HE, HEE, HQ, MixMate | Volume resistance | ≤ 2mΩ |

Classifications

| | | | |
|------------|-------------|------------|-------------|
| ETIM 3.0 | EC000796 | ETIM 4.0 | EC000796 |
| ETIM 5.0 | EC000796 | ETIM 6.0 | EC000796 |
| UNSPSC | 30-21-18-01 | eClass 5.1 | 27-14-34-19 |
| eClass 6.2 | 27-26-12-02 | eClass 7.1 | 27-44-02-04 |
| eClass 8.1 | 27-44-02-04 | eClass 9.0 | 27-44-02-04 |
| eClass 9.1 | 27-44-02-04 | | |

Approvals

Approvals



ROHS Conform

Downloads

| | |
|--------------------|---|
| Brochure/Catalogue | CAT 3 HDC 17/18 EN FL FIELDWIRING EN |
| Engineering Data | EPLAN, WSCAD, Zuken E3.S |

Data sheet

**Crimping contact
HDC-C-HE-SM2.5AG**

Weidmüller Interface GmbH & Co. KG
 Klingenbergstraße 16
 D-32758 Detmold
 Germany
 Fon: +49 5231 14-0
 Fax: +49 5231 14-292083
 www.weidmueller.com

Drawings

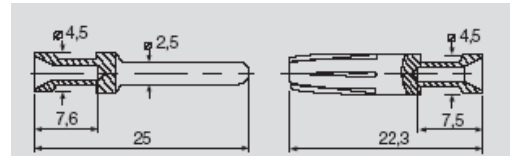

| Leiterquerschnitt | Abisolierlänge | |
|-----------------------------|----------------|--------|
| 0,50 mm ² | AWG 20 | 7,5 mm |
| 0,75 - 1,00 mm ² | AWG 18 | 7,5 mm |
| 1,50 mm ² | AWG 16 | 7,5 mm |
| 2,50 mm ² | AWG 14 | 7,5 mm |
| 4,00 mm ² | AWG 12 | 7,5 mm |

